

BOSE[®]

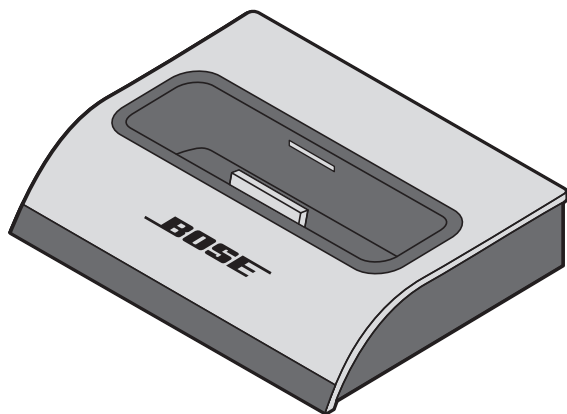

WAVE[®] CONNECT KIT

Owner's Guide | Bedienungsanleitung | Guía de usuario
Notice d'utilisation | Manuale di istruzioni | Gebruiksaanwijzing
คู่มือผู้ใช้ | 사용자 안내서 | 用戶指南 | دليل المالك

IMPORTANT SAFETY INSTRUCTIONS

Please read this owner's guide

Please take the time to follow the instructions in this owner's guide carefully. It will help you set up and operate your system properly and enjoy all of its advanced features. Please save this owner's guide for future reference.

 **WARNING:** To reduce the risk of fire or electrical shock, do not expose the product to rain or moisture.

 **WARNING:** Do not expose this apparatus to dripping or splashing, and do not place objects filled with liquids, such as vases, on or near the apparatus. As with any electronic products, use care not to spill liquids into any part of the system. Liquids can cause a failure and/or a fire hazard.





 The lightning flash with arrowhead symbol within an equilateral triangle alerts the user to the presence of uninsulated, dangerous voltage within the system enclosure that may be of sufficient magnitude to constitute a risk of electrical shock.

 The exclamation point within an equilateral triangle, as marked on the system, is intended to alert the user to the presence of important operating and maintenance instructions in this owner's guide.

Class B emissions

This product complies with the Canadian ICES-003 Class B specifications.

 **WARNING:** Do not place any naked flame sources, such as lighted candles, on or near the apparatus.

 **CAUTION:** Make no modification to the system or accessories. Unauthorized alterations may compromise safety, regulatory compliance, and system performance.

 **CAUTION:** Bose recommends using a high-quality, safety agency-approved (i.e. UL, ETL) surge suppressor on all electronic equipment.

 This product conforms to all EU directive requirements as applicable by law. The complete Declaration of Conformity can be found at www.Bose.com/compliance.

Note: Where the mains plug or appliance coupler is used as the disconnect device, such disconnect device shall remain readily operable.

Note: The product must be used indoors. It is neither designed nor tested for use outdoors, in recreation vehicles, or on boats.

Note: This product is intended to be used only with the power supply provided.

 **CAUTION:** Long-term exposure to loud music may cause hearing damage. It is best to avoid extreme volume when using headphones, especially for extended periods.

IMPORTANT SAFETY INSTRUCTIONS

- 1. Read these instructions** – for all components before using this product.
- 2. Keep these instructions** – for future reference.
- 3. Heed all warnings** – on the product and in the owner's guide.
- 4. Follow all instructions.**
- 5. Do not use this apparatus near water or moisture** – Do not use this product near a bathtub, washbowl, kitchen sink, laundry tub, in a wet basement, near a swimming pool, or anywhere else that water or moisture are present.
- 6. Clean only with a dry cloth** – and as directed by Bose Corporation. Unplug this product from the wall outlet before cleaning.
- 7. Do not install near any heat sources, such as radiators, heat registers, stoves, or other apparatus (including amplifiers) that produce heat.**
- 8. Protect the power cord from being walked on or pinched, particularly at plugs, convenience receptacles, and the point where they exit from the apparatus.**
- 9. Only use attachments/accessories specified by the manufacturer.**
- 10. Unplug this apparatus during lightning storms or when unused for long periods of time** – to prevent damage to this product.
- 11. Refer all servicing to qualified service personnel. Servicing is required when the apparatus has been damaged in any way: such as power-supply cord or plug is damaged; liquid has been spilled or objects have fallen into the apparatus; the apparatus has been exposed to rain or moisture, does not operate normally, or has been dropped** – Do not attempt to service this product yourself. Opening or removing covers may expose you to dangerous voltages or other hazards. Please call Bose to be referred to an authorized service center near you.
- 12. To prevent risk of fire or electric shock, avoid overloading wall outlets, extension cords, or integral convenience receptacles.**
- 13. Do not let objects or liquids enter the product** – as they may touch dangerous voltage points or short-out parts that could result in a fire or electric shock.
- 14. See product enclosure for safety-related markings.**
- 15. Use proper power sources** – Plug the product into a proper power source, as described in the operating instructions or as marked on the product.

Contents of your kit



Dock with adapter insert



RCA audio cable



3.5 mm audio cable

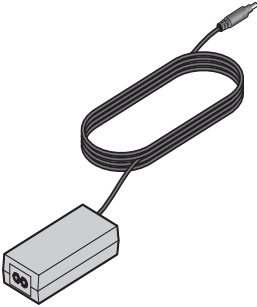

Power pack



AC power cord

Compatibility

This kit is compatible with most iPod models (see page 15 for a complete list).

For the Wave® connect kit to work as expected, your iPod must have the latest version of iPod software installed. If you need to upgrade, visit the Apple website and follow the instructions there.

Recommended placement

We recommend that you place the dock to the right of your Bose® Wave® music system or Acoustic Wave® music system so the iPod has minimal effect on AM reception.

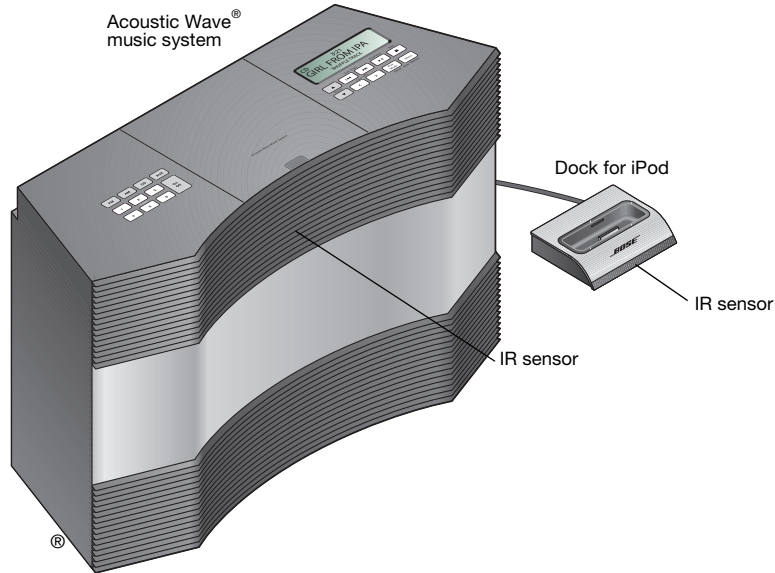
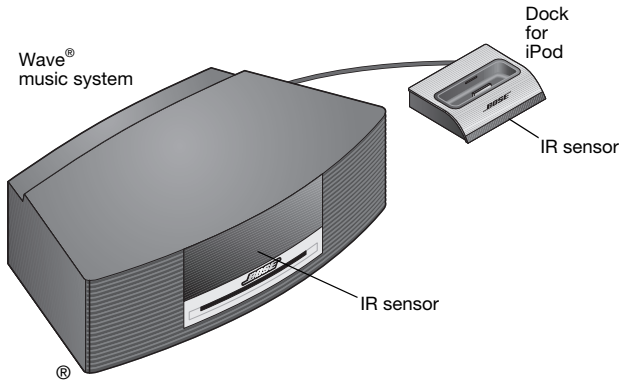

Be sure the IR sensor on the front of the dock is visible and aligned with the Wave® system IR sensor so both products respond to the remote.

Connecting the products

Please be sure to make all other connections before plugging your Wave® system into a power outlet.

Use the supplied audio cable that is appropriate for your Wave® system.

For a Wave® music system or Wave® radio: Use the mini audio cable and connect AUDIO OUT on the dock to AUX IN.

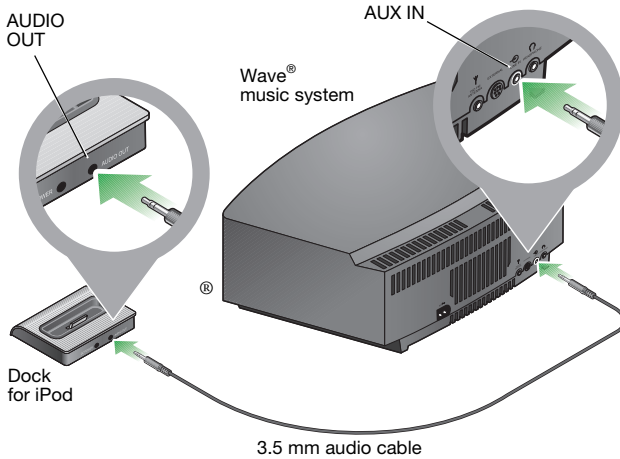

For an Acoustic Wave® music system: Use the RCA audio cable and connect AUDIO OUT on the dock to AUX IN.

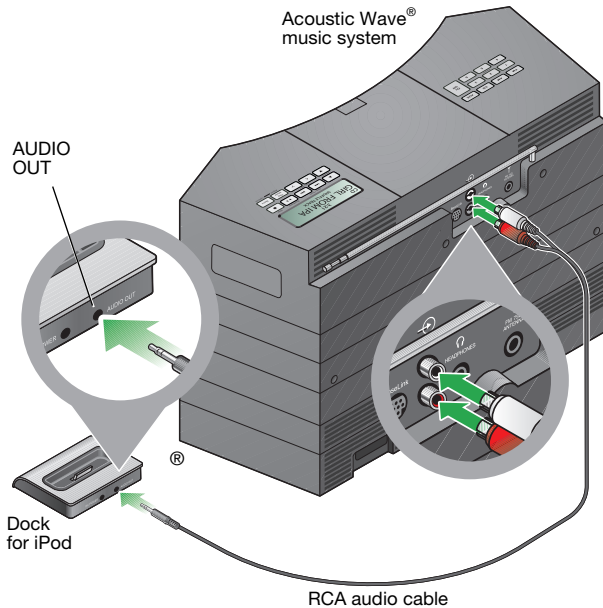

For a Wave® music system or Acoustic Wave® music system with Multi-CD Changer: Use the RCA audio cable and connect from AUDIO OUT on the dock to AUX 1 L and R.

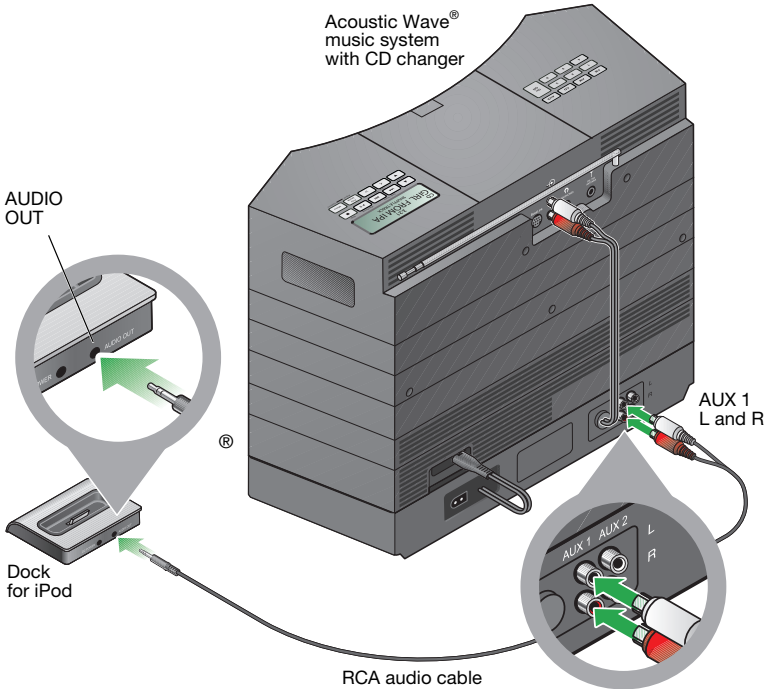
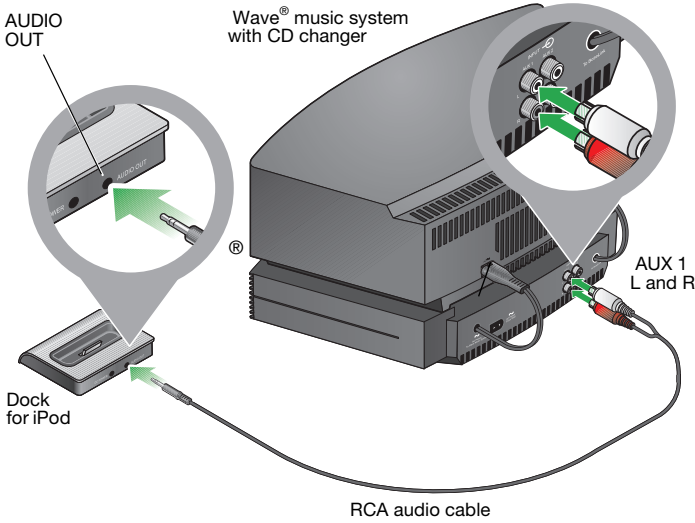

Connecting the dock to power

1. Connect the free end of the power pack cable to the dock.
2. Connect the AC power cord to the power pack.
3. Plug the AC power cord into an AC (mains) outlet.

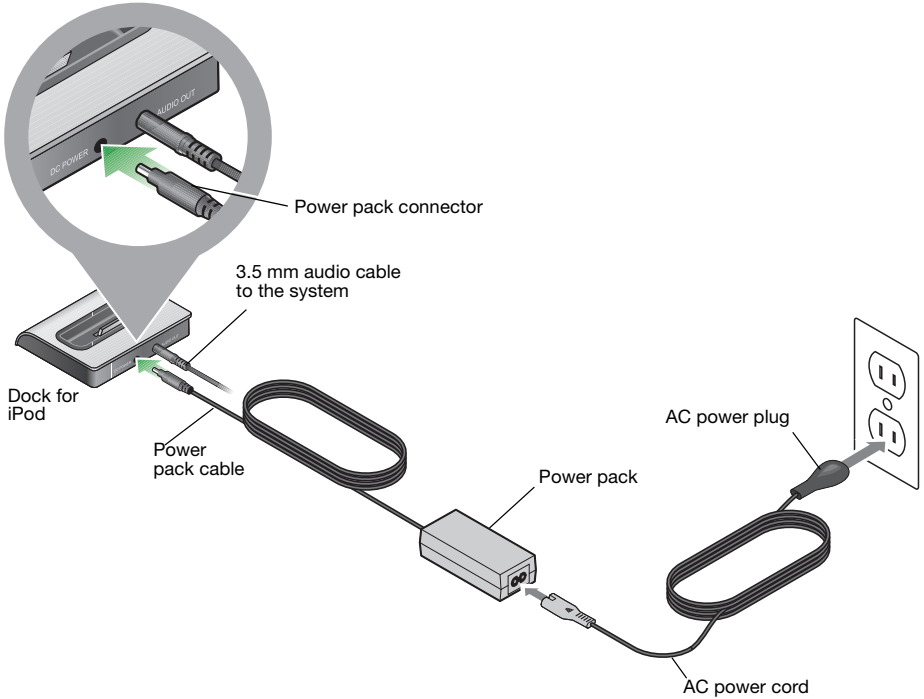

Controlling your iPod and Wave® system

The remote that came with your Wave® music system or Wave® radio can also control the Wave® connect kit. (The remote is not included in the connect kit.)

Most of the remote control buttons are described in the owner's guide that came with your Wave® system. The remote buttons described below provide added features.

Important note: The Sleep button and three Alarm buttons on the remote control affect system sound sources only. They do not control the iPod and cannot be set for use with that source.

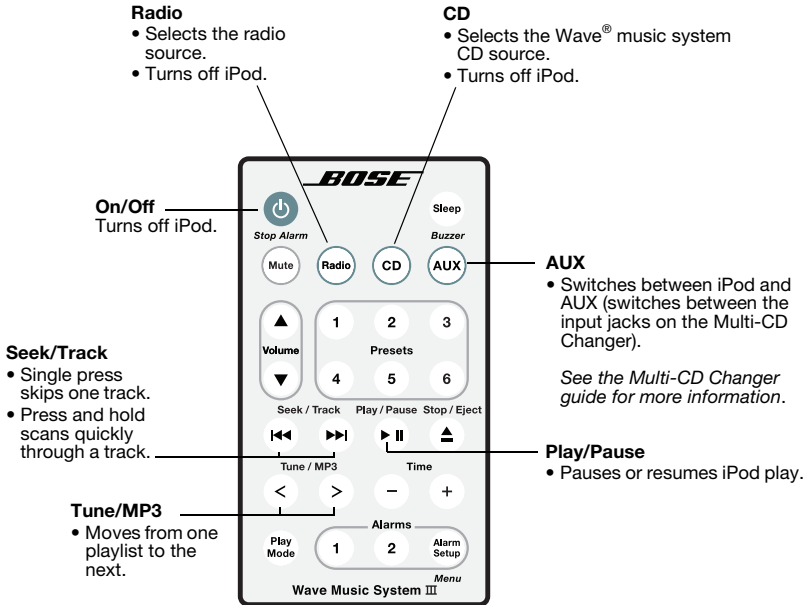

Note: The Stop/Eject button does not appear on the Wave® radio remote control.

The response to some remote commands depends on which source (Radio/CD/iPod/AUX) is playing. If the remote does not work as you expect, press the button for that source to reset the intended mode of operation.

Note: The remote originally included with the Wave® radio II did not include a Play/Pause button. However, the system will still function properly once you initiate playback on the iPod. If you own this system and prefer to purchase a remote control that includes a Play/Pause button, please contact Bose using the contact information provided on page 16.

USING YOUR WAVE® CONNECT KIT

The remote that came with your Acoustic Wave® music system can also control the Wave® connect kit.

Most of the remote control buttons are described in the owner's guide that came with your Wave® system. The remote buttons described below provide added features.

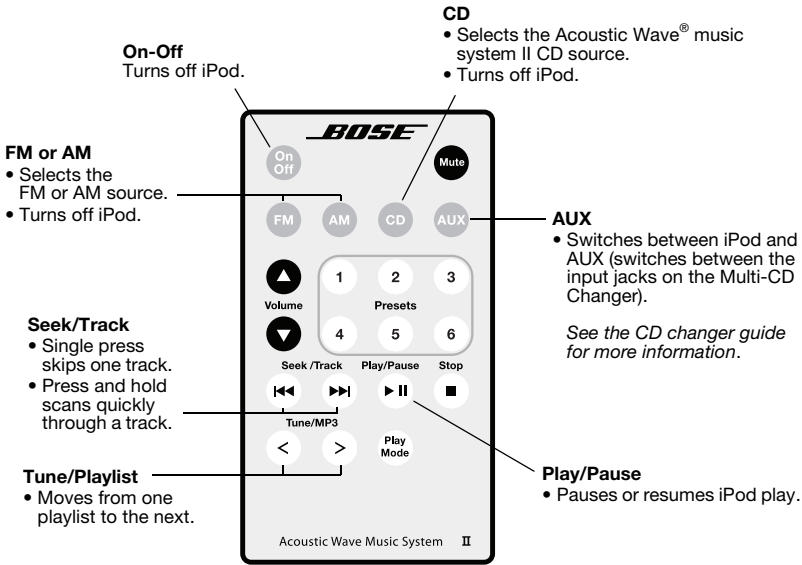

The response to some remote commands depends on which source (FM/AM/CD/iPod/AUX) is playing. If the remote does not work as you expect, press the button for that source to reset the intended mode of operation.

Docking your iPod

Insert your iPod firmly into the dock and make sure it is securely seated in the dock adapter. Your iPod turns on in a paused state and begins charging, as needed. Even if the paused iPod turns off automatically, it continues to charge.

If you prefer, you can replace this dock adapter with the adapter specifically designed for and provided with your iPod. Use a fingernail or a slender tool carefully to pry the adapter free, as shown.

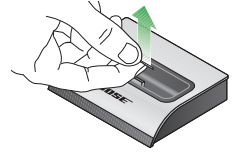

Playing your iPod

Be sure to aim the remote so its signals reach the IR sensor on the front of the dock. Then use these buttons as follows:



Press **AUX** to turn on your system and begin iPod playback.

Play / Pause



Press **Play/Pause** to pause or resume iPod play.

Tune / MP3



Press **Tune/MP3** to move from one playlist to another. Then press **Play** to hear that list play.

Seek/Track



Press **Seek/Track** once to skip back or ahead one track.

Press and hold **Seek/Track** to scan through a track.



Press **Volume** to adjust the sound volume.







Note: *Volume changes using the iPod controls will not affect the Wave® system volume.*



Press **On/Off** once to turn off both products, aiming the remote at the dock until the iPod turns off.

Press any source button to turn off the iPod and listen to that source.

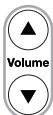
Troubleshooting

Problem	What to do	
The remote does not control the iPod	<p>Press AUX to reset the mode of operation for the iPod.</p> <p>You may then need to press Play/Pause to resume play.</p>	 Play / Pause 
The iPod is on when it should not be	<p>If the system is off or you are playing another source, press AUX.</p> <p>Then press On/Off or another source button. With the remote aimed properly, your iPod should turn off within 2 seconds.</p>	 
The volume varies when the iPod plays different songs	<p>Use Volume to set the volume to the level you prefer for a particular song.</p> <p><i>The recording quality of songs varies, producing inconsistent play volumes.</i></p>	
Poor AM reception	<p>Make sure the iPod is turned off to help prevent interference. (Refer to “The iPod is on when it should not be.”)</p> <p>Position the dock to the right of the system to minimize interference with the built-in AM antenna.</p>	
The iPod is connected to the Multi-CD Changer and it is on but does not play	<p>Be sure the audio cable from the dock is connected to INPUT AUX 1 on the changer.</p> <p>Press AUX and check to see that AUX 1 appears on the Wave® system display.</p> <p>You may then need to press Play/Pause.</p>	 Play / Pause 
The Wave® system speakers play even when headphones are plugged into the docked iPod	<p>Connect the headphones to the mini jack on the Wave® system.</p> <p><i>This silences the system so the sound plays through the headphones only.</i></p>	

Limited warranty

Who is covered:

This warranty is extended only to the original end-use purchaser or the person receiving the product as a gift, and shall not be extended to any other person or transferee.

What is covered/For how long:

For a period of 1 year (2 years, European Union) from the date of retail purchase by the original end-use purchaser, Bose warrants that this product, when delivered to you in new condition, in original packaging, from a Bose® authorized reseller and used in normal conditions, is free from any defects in manufacturing, materials and workmanship.

What is not covered:

This warranty does not cover defects resulting from improper or unreasonable use or maintenance; failure to follow operating instructions; accident; excess moisture; insects; lightning; power surges; connections to improper voltage supply; unauthorized alteration or modification of original condition; damages caused by inadequate packing or shipping procedures; loss of, damage to, or corruption of, stored data; damages caused by use with non-Bose products; product that requires modification, or adaptation to enable it to operate in any country other than the country for which it was designed, manufactured, approved, and/or authorized, or repair of products damaged by these modifications; and products purchased from unauthorized dealers.

What we will do:

During the warranty period, we will, at our sole option, repair or replace (using new or refurbished replacement parts) any defective parts within a reasonable period of time and free of charge.

What we will not do:

Pay shipping, insurance, or transportation charges from you to us, or any import fees, duties, and taxes.

What you must do to obtain Limited Warranty Service:

Return product, with proof of purchase from an authorized Bose® dealer, using the following procedures:

1. Contact the Bose organization in your country/region (visit Global.Bose.com for Bose contact information in your country/region) for specific return and shipping instructions;
2. Label and ship the product, freight prepaid, to the address provided by the Bose organization in your country; and
3. Place any necessary return authorization number prominently on the outside of the carton. Cartons not bearing a return authorization number, where required, will be refused.

Other conditions:

THE PROVISIONS OF THIS LIMITED WARRANTY ARE IN LIEU OF ANY OTHER WARRANTY, WHETHER EXPRESSED OR IMPLIED, WRITTEN OR ORAL, INCLUDING ANY WARRANTY OF MERCHANTABILITY OR FITNESS FOR A PARTICULAR PURPOSE. BOSE CORPORATION'S MAXIMUM LIABILITY SHALL NOT EXCEED THE ACTUAL PURCHASE PRICE PAID BY YOU FOR THE PRODUCT. IN NO EVENT SHALL BOSE BE LIABLE FOR LOSS OF, DAMAGE TO, OR CORRUPTION OF, STORED DATA, OR FOR SPECIAL, INCIDENTAL, CONSEQUENTIAL, OR INDIRECT DAMAGES HOWSOEVER CAUSED, INCLUDING WITHOUT LIMITATION THE REPLACEMENT OF EQUIPMENT AND PROPERTY, AND ANY COSTS OF RECOVERING, PROGRAMMING OR REPRODUCING ANY PROGRAM OR DATA STORED IN OR USED WITH YOUR BOSE PRODUCT. This warranty is void if the label bearing the serial number has been removed or defaced.

Other legal rights:

This limited warranty gives you specific legal rights, and you also may have other rights that vary from state to state or country to country. Some places do not allow limitations on implied warranties or the exclusion or limitation of incidental or consequential damages, so the above limitations or exclusions may not apply to you.

Made for:

- iPod touch (1st, 2nd, 3rd, and 4th generation)
- iPod nano (1st, 2nd, 3rd, 4th, 5th, and 6th generation)
- iPod classic
- iPod with video

Apple, iPod, iPod classic, iPod nano, and iPod touch are trademarks of Apple Inc., registered in the U.S. and other countries. "Made for iPod" means that an electronic accessory has been designed to connect specifically to iPod and has been certified by the developer to meet Apple performance standards. Apple is not responsible for the operation of this device or its compliance with safety and regulatory standards. Please note that the use of this accessory with iPod may affect wireless performance.

The distinctive design of the Wave® music system, Acoustic Wave® music system, and Wave® radio is a registered trademark of Bose Corporation in the U.S. and other countries.



352834-0010

BOSE[®]
Better sound through research[®]

2012 Bose Corporation, The Mountain,
Framingham, MA 01701-9168 USA
AM352834 Rev 01