

***Bose® Model PM-1
Portable Compact Disc Player***

Owner's Guide

Declaration of Conformity



DECLARATION OF CONFORMITY

We, the offerer:
Bose Corporation, The Mountain, Framingham, MA
01701-9168 USA

acknowledge our sole responsibility,
that the product:

Kind of equipment: Compact Disc Player

Type designation: Bose® Model PM-1
Portable Compact Disc
Player

In accordance with EMC Directive 89/336/EEC
and Article 10(1) of the Directive,
is in compliance with the following
norm(s) or document(s)

Technical regulations: EN 55013, EN 55020
EN 61000-3-2, -3-3, -4-2, -4-4, -4-5

&

in accordance with the Low Voltage Directive 73/23/EEC,
is in compliance with the following norm(s) or document(s):

Technical regulations: EN 60065, EN 60825

Accredited by:

Bose Corporation, The Mountain,
Framingham, MA 01701-9168 USA

24 September 2003

Nic Merks

Bose Products B.V.
Nijverheidstraat 8, 1135 GE Edam
The Netherlands

Vice President Europe
Manufacturer's authorized
EU representative

Safety Information

Class 1 Laser Product

This CD Player is classified as a CLASS 1 LASER PRODUCT according to EN 60825-1:1994 + A11. The CLASS 1 LASER PRODUCT label is located on the bottom of the player.

CLASS 1	LASER PRODUCT
KLASSE 1	LASER PRODUKT
LUOKAN 1	LASER LAITE
KLASS 1	LASER APPARAT

- ▲ WARNING:** *This product utilizes a laser. Invisible radiation is present when unit is opened and interlock failed or defeated.*
- ▲ WARNING:** *Use of controls or adjustments or performance of procedures other than those specified herein may result in hazardous radiation exposure. The CD player should not be adjusted or repaired by anyone except properly qualified service personnel.*
- ▲ WARNING:** *Dispose of used batteries promptly and properly, following any local regulations. Do not incinerate.*



Information about products that generate electrical noise.

This equipment has been tested and found to comply with the limits for a Class B digital device, pursuant to Part 15 of the FCC rules. These limits are designed to provide reasonable protection against harmful interference in a residential installation. This equipment generates, uses, and can radiate radio frequency energy and, if not installed and used in accordance with the instructions, may cause harmful interference to radio communications. However, this is no guarantee that interference will not occur in a particular installation. If this equipment does cause harmful interference to radio or television reception, which can be determined by turning the equipment off and on, you are encouraged to try to correct the interference by one or more of the following measures:

- Reorient or relocate the receiving antenna.
- Increase the separation between the equipment and receiver.
- Connect the equipment to an outlet on a different circuit than the one to which the receiver is connected.
- Consult the dealer or an experienced radio/TV technician for help.

Note: Modifications or adjustments to this equipment which are not expressly approved by the manufacturer may void the user's right or authority to operate this equipment.

This product complies with the Canadian ICES-0003 Class B specifications.

Safety Information

- ⚠ Caution:** Long term exposure to loud music may cause hearing damage. It is best to avoid extreme volume when using headphones with this CD Player, especially for extended periods.
- ⚠ Caution:** Do not use this product with headphones when operating a motor vehicle on a public road, or where the inability to hear outside sounds may present a danger.
- ⚠ Caution:** If you hear no sound when playing a disc, DO NOT turn the volume up high because music could suddenly start at high volume. Turn the volume control to the lowest level before starting playback and slowly increase volume to the desired level.
- 🎵 Note:** If the CD player is brought from a cold to a warm location, moisture may condense inside, causing it to stop working. Should this occur, remove the disc and leave the player in a warm location for several hours to allow the moisture to evaporate.
- 🎵 Note:** Use the player with 2 AA batteries (LR06 alkaline). The CD Player is not supplied with an AC adapter. Use only a safety agency approved 6V DC 350mA AC adapter. Plus pole (+) to the center pin of the 3.5mm socket. When the unit is not used, be sure to disconnect the AC power adapter.

Customer Service

For additional help in solving problems, contact your Bose dealer. Or, to contact Bose® Customer Service, refer to the list on page 13 of this guide.

About Your CD Player

Before you use the Bose® PM-1 Portable Compact Disc Player

This guide will help you enjoy the compact disc player that came with your Bose® product.

Load the Batteries

Slide the compartment door as shown. The diagram next to the compartment door shows the positioning of the positive and negative battery terminals.

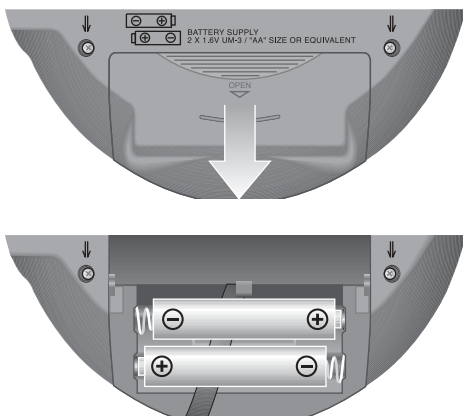

Unlock the Hold Switch

The Hold switch, located on the back of the player, may be ON when shipped from the factory. This prevents the controls from operating.

Move the Hold switch to OFF to disable Hold and unlock all controls. Turn Hold ON to prevent accidental operation of the controls.

Use

Connecting Headphones

To make the headphone connection, insert the headphone plug in the jack on the side of the CD player.

Selecting Compatible Discs

Your CD player can play audio CDs, CD-Rs, and CD-RWs.

The CD Player Controls

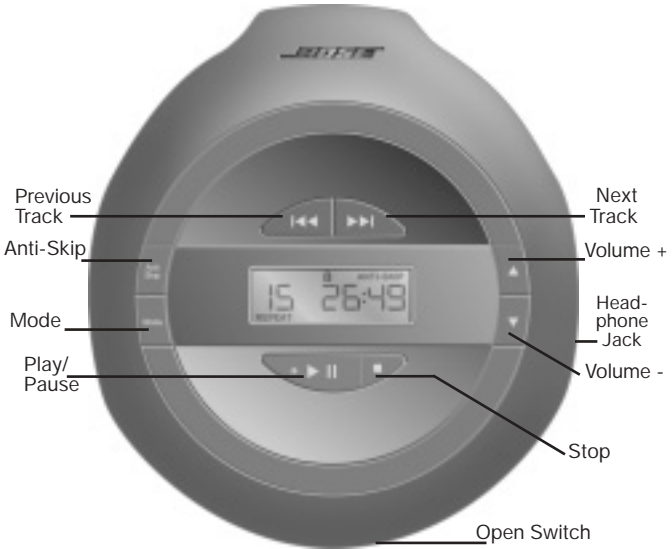

The CD player controls are explained on the following pages.

CD Player Controls

Open Switch

Slide the switch to the right to open the CD compartment. Place a CD inside the compartment, with the printed side facing upwards. Press down gently until it clicks in place. Press the CD door to close.

 indicates the compartment door is open.



Play/Pause Button

Press to turn the CD player ON or to play a track when the player is stopped, paused, or OFF. The CD player will continue playing until Pause or Stop are pressed or all tracks are played.

When a CD is playing, press Play/Pause to pause a track. The player will remain paused until:

- Play/Pause is pressed to resume play, or,
- Stop is pressed.

When the player is OFF or stopped, press Play/Pause to play the first track on the CD.



Stop Button

Press to stop play of the current track.

Play remains stopped until: Play/Pause is pressed to play the track, or, Stop is pressed to turn the player OFF.

While a CD is playing, press the Stop button twice to turn the player OFF.

If a track is paused, press Stop to display the total number of tracks and total time of the CD. Play remains stopped.

Use

Next Track/Previous Track Button

 When a CD is being played, press this button to advance to the next track. If the last track on a CD is being played, pressing Next Track will advance play to the first track on the CD.



 When a CD is being played, press the Previous Track button to play the beginning of that track. Press the button again, within one second of the first press, to play the previous track.

When a track is being played, press and hold the Next Track or Previous Track button to scan forward or backward through the current track. When the track ends, scanning will continue until the button is released.

When no track is being played, press and hold the Next Track or Previous Track button to scroll forward or backward across all tracks until the button is released.

Volume Up/Volume Down Buttons

Use these buttons to adjust playback volume. The display shows a volume of 4 when the player is first turned on. There are 31 volume settings, from a minimum of 0 to a maximum of 31.

Press the Volume Up  or Volume Down  button once to increase or decrease the volume by one setting.

Press and hold either volume button to continuously increase or decrease the volume settings.

Volume may be adjusted during playback or when the player is stopped.

VOLUME displays when the volume is adjusted.

Anti-Skip Button



The Anti-Skip button reduces skipping if the CD player is moved during playback. This feature is ON by default.

ANTI-SKIP displays when the feature is ON.

Press the Anti-Skip control to disable or re-activate this feature during Play, Pause, or Stop modes.

Note: *Activating Anti-Skip may degrade playback quality.*

Hold



You can lock the CD player to prevent the settings from changing during playback or when the player is OFF.

Move the Hold switch, located on the back of the player, to ON to enable Hold and lock all controls.

🔒 is displayed to indicate Hold is activated.

You will not be able to operate the controls of the CD player until the Hold switch is set to OFF.

When the player is OFF, **🔒** will flash momentarily when you press Play/Pause when Hold is ON.

The Hold symbol is not displayed when Hold is OFF.

Use

The CD Display Window



Track and Time

When a CD is first loaded, and the Play/Pause button is pushed, the numerals in the center of the window show the total number of tracks and the total time of the CD for one second.

When the volume is being adjusted, the volume graphic appears at the top left of the display, and the volume level, from 0 to 31, is displayed in the same location as the track number.

When a CD track is playing, the track number and the elapsed time of that track is displayed. The track number and elapsed time are displayed immediately after Play has been pressed, and remain on the display window until the selected track has ended.

When a CD is paused, the track number continues to be displayed, and the elapsed time flashes at the point where playback was paused.

When the CD player is OFF, the display is blank.

Low Battery Symbol

When about 10 minutes of playing time remain, the low battery symbol appears and flashes until the player is turned OFF or the battery runs out of power.

Error Text

This indicates there is no CD in the player, the CD is upside-down, or its format cannot be read. The message displays for thirty seconds and the player turns OFF.

Play Modes



Press the Mode button to cycle through the five Play Modes:

Normal – press Play

This is the default mode when Play is pressed. No graphic is displayed.

Repeat – press Mode once

In Normal mode, press the Mode button once to repeat the selected track. The track will be repeated until Next Track/Previous Track, Mode, or Stop is pressed.

REPEAT indicates *Repeat* mode is selected.

Repeat All – press Mode twice

In Normal mode, press the Mode button twice to repeat all the tracks on the CD. The CD will repeat until the Play Mode is changed, or the player is Stopped.

REPEAT ALL indicates *Repeat All* mode is selected.

Intro – press Mode three times

In Normal mode, press the Mode button three times to play approximately ten seconds of each track on the CD. When all tracks have been played, the player stops. If no track is playing when Intro is activated, press Play to begin playback in Intro mode.

INTRO indicates *Intro* mode is selected.

Shuffle – press Mode four times

In Normal mode, press the Mode button four times to play all the tracks on the CD in random order. When all tracks have been played, the player stops.

If no track is playing when Shuffle is activated, press Play to begin playback in Shuffle mode. The player skips to the next shuffled track and begins playback.

SHUFFLE indicates *Shuffle* mode is selected.

Battery Replacement

The CD player uses two AA (LR06 alkaline) batteries. Do not mix old and new batteries.

Insert the batteries into the player with the positive and negative battery terminals aligned with + and – symbols shown on the case next to the battery compartment

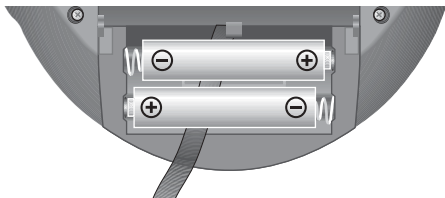

- ♪ **Note:** *You can use rechargeable batteries (NiMH, composed of nickel metal hydride, are recommended). They average half the life of alkaline batteries. However, the low battery symbol is not set for such batteries and will not be a reliable indicator of their remaining battery life. Do not mix alkaline and rechargeable batteries.*

Cleaning the CD Player

Cleaning is not necessary. However, you can simply wipe the outside surfaces with a soft cloth, as needed.

Europe

Phone: 0299 390111

Fax: 0299 390114

Australia

Phone: 1800 023 367

www.bose.com.au

Belgique/Belgi

Phone: 012 390800

Fax: 012 390840

Canada

1-800-4652673

Danmark

Phone: 04343 7777

Fax: 04343 7818

Deutschland

Phone: 06172-71040

Fax: 06172-710419

www.bose.de

France

Phone: 01-30616363

Fax: 01-30614105

Ireland

Phone: 042-9661988

Fax: 042-9661988

www.bose.ie

Italia

Phone: 066-5670802

Fax: 066-5680167

Nederland

Phone: 0299 390111

Fax: 0299 390109

New Zealand

Phone: 61 2 8737 99567

(Australian number)

Norge

Phone: 62 82 15 60

Fax: 62 82 15 69

sterreich

Phone: 01-60404340

Fax: 01-604043423

Schweiz

Phone: 061-9815544

Fax: 061-9815502

Sverige

Phone: 031-878850

Fax: 031-274891

United Kingdom

Phone: 0800 614293

0870 7414500

Fax: 08707414545

www.bose.co.uk

United States

Phone: 1-888-757-9943

Fax: 1-877-289-4366

www.bose.com

BOSE[®]
Better sound through research[®]

©2004 Bose Corporation
The Mountain, Framingham, MA 01701-9168 USA
273580-ENGvo AM Rev.00